

COMPRESSOR

Displacement (cm ³)	25.93
Diameter (mm)	39.98
Stroke (mm)	20.65
Net Weight (Kg)	22.7
Oil type	ISO VG 46 ESTER
Oil charge (cm ³)	887

MOTOR

Approximate Power (CV)	3/4
Voltage/Frequency (V/Hz)	220V 50Hz
Voltage range (V)	198-264
Code	82,104
Type	CSIR
Phase number	1 PH
Locked rotor current (A)	32.0
Main W. resist. at 25°C (Ω)	1.99
Start W. resist. at 25°C (Ω)	19.37

APPLICATION

Application	High/Mid. back pressure
Refrigerant	R134a
Evaporating (°C)	-25 to 10
Expansion	Capillar/Valve
Comp. cooling	Fan cooled
Max. ambient temp. (°C)	43

NOMINAL PERFORMANCE	CYCLE C	CYCLE D
Cooling capacity (W)	2071	2489
Input power (W)	989	1030
EER (kcal/Wh)	1.80	2.07
COP (W/W)	2.09	2.41
Current (A)	6.11	6.30

TEST CONDITIONS

Evaporating temp. (°C)	5.0	7.2
Condensing temp. (°C)	55.0	55.0
Liq.t. entering expan. (°C)	55.0	46.0
Ambient t. and return (°C)	32.0	35.0
Tens/Freq (V/Hz)	220V 50Hz	220V 50Hz

ELECTRICAL COMPONENTS

Relay	3ARR 18A 79B	
Pick-Up (A)	16,70	
Drop-Out (A)	14,00	
Protector	MRA38088	T0419
Current (A)	22.0	22.0
Time check (seg)	7.5-14	7.5-14
Disc temp. (Open/Close) (°C)	105.0 / 57.0	105.0 / 61.0
Starting capacitor (μF/V)/F/V)	64- 77 / 330	

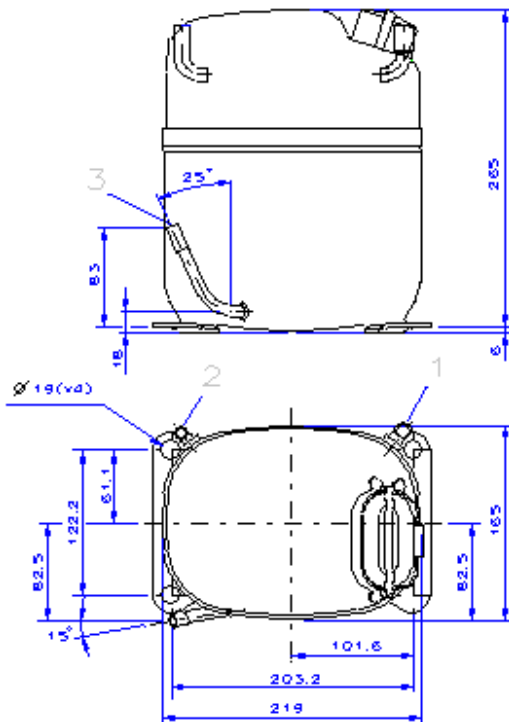
DIMENSIONS AND ELECTRICAL DIAGRAM

DESIGNATION	INTERNAL DIAM. (MM)
1 Suction	12,7
2 Service	9,6
3 Discharge	8,0

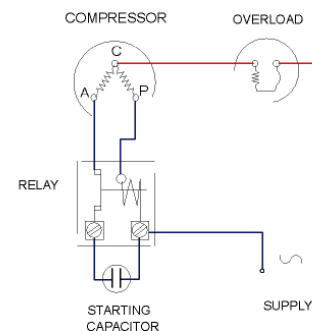
CSIR

TEST CONDITIONS

Voltage/frequency	220V 50Hz
Ambient t. and return	35 °C
Liq.t. entering expan.	Subcooling 9 K

MASS FLOW

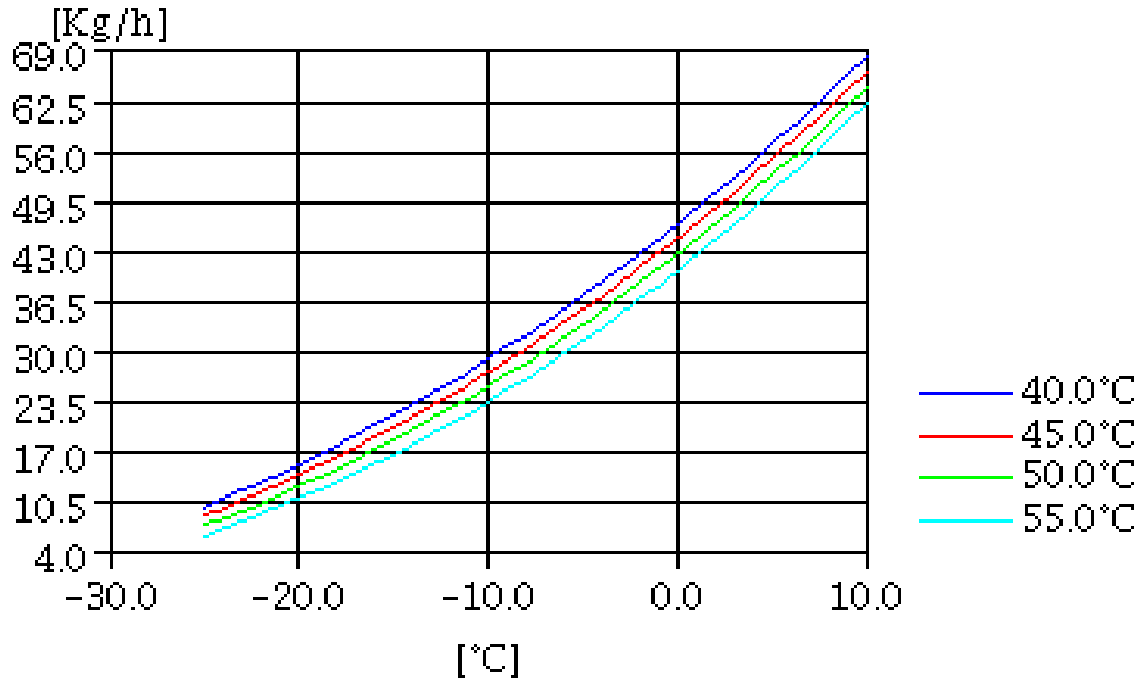

CONSUMPTION

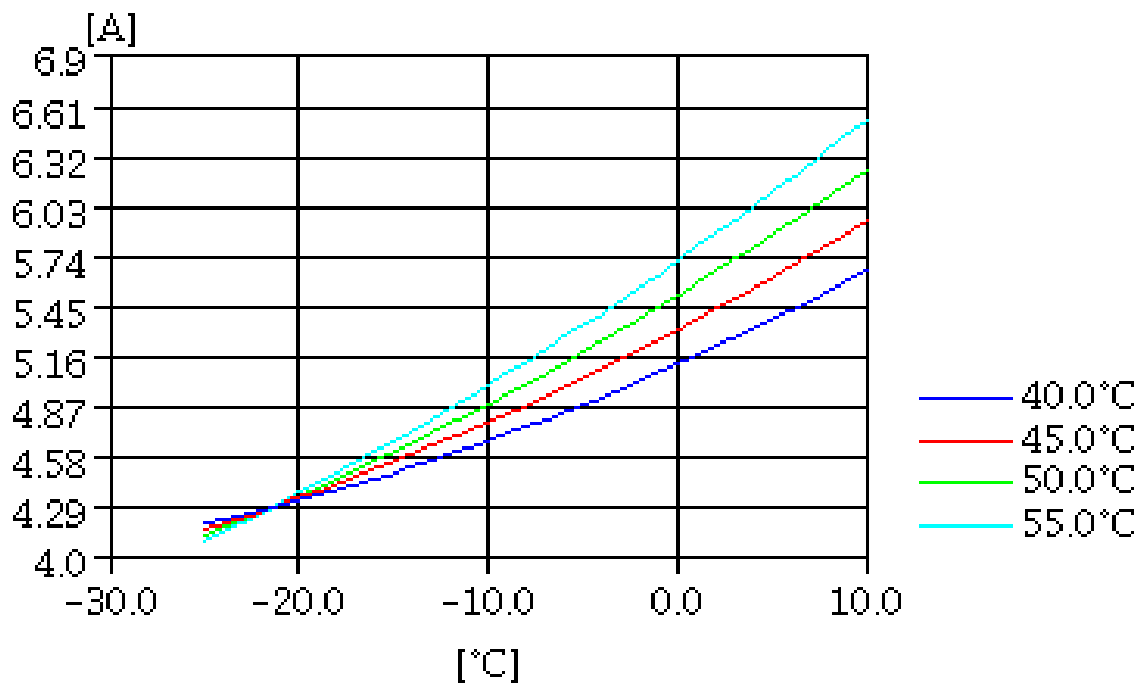

TEST CONDITIONS

Voltage/frequency	220V 50Hz
Ambient t. and return	35 °C
Liq.t. entering expan.	Subcooling 9 K

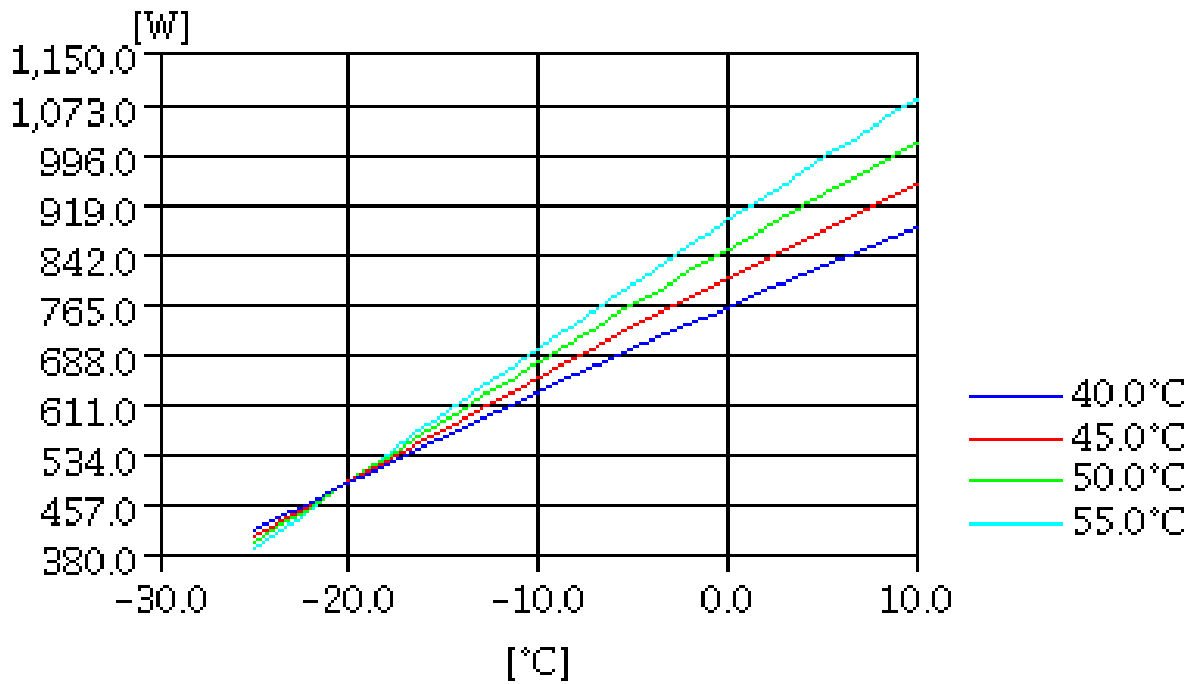
INPUT W

COOLING CAPACITY
