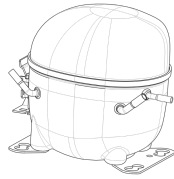

220-240V 50 1~**GENERAL DATA****Application:** HBP**Refrigerant:** R600a**Evaporating Temperature Range:** -15°C to 10°C**Compressor Cooling:** Static**Type:** Hermetic reciprocating**Technology Type:** On-Off**Expansion Device:** Capillary Tube**Packing Quantity:** Multi - 74 pcs**Displacement:** 14.28 cm³**Horse power:** 1.4 hpApprovals:   **MECHANICAL DATA****Bore:** 30.16 mm**Stroke:** 20 mm**Oil Charge:** 350ml +/-15ml**Free Internal Volume:** 2.3 cm³**Maximum Recommended Refrigerant Charge:** 150 g**Oil Type Configuration:** Alkylbenzene**Oil Type Viscosity:** ISO5**Compressor pressurization:** Without dry air charge**Weight:** 10.9 kg**ELECTRICAL DATA****Motor Type:** RSCR**Starting Torque:** LST**Voltage working range at 50 Hz:** 198-254 V**Maximum Motor Temperature:** 130 °C**Start Winding Resistance:** 17.65 Ω (± 10%) at 25°C**Run Winding Resistance:** 14.15 Ω (± 10%) at 25°C**Locked Rotor Amperage (LRA):** 15 A**MOUNTING ACCESSORIES**

	Description	Code
Terminal Board:	no	-
Overload Protector Bracket:	no	-
Capacitor Bracket:	no	-
Rotolock valve:	no	-
Sleeves:	no	-
Cover:	yes	2075282
Anchorage:	yes	1027058
Grommets:	yes	2221011
Washer:	yes	2211047
Pin:	yes	2037140
Clip:	yes	2220020

ELECTRICAL COMPONENTS

	Component type	Description	Code
Starting Device:	PTC	PTC 230V	1260011
Motor Protection:	External 3/4"	AE19BU8	2288511
Run Capacitor:		8 MFD	2253328

EXTERNAL CHARACTERISTICS**Base Plate:** European**Tray Holder:** No**Height:** 206 mm

	Internal Diameter (mm)	Material	Shape
Suction Connector	6.1	Copper	Slanted 42°
Discharge Connector	4.86	Copper	Straight
Process Connector	6.1	Copper	Slanted 42°

RATED POINT DATA

Cooling Capacity (W)	Power Consumption (W)	Current Consumption (A)	Gas Flow Rate (kg/h)	Efficiency (W/W)
±5%	±5%	±5%	±5%	±7%
847	269	1.24	10.14	3.15

Test condition: ASHRAE, Static, Return Gas 35°C, Subcooling 8.3K, Evaporating: 7.2°C, Condensing: 54°C, Ambient: 35°C

PERFORMANCE CURVE DATA

220V 50Hz

Condensing Temperature (°C)	Evaporating Temperature (°C)	Cooling Capacity (W)	Power Consumption (W)	Current Consumption (A)	Gas Flow Rate (kg/h)	Efficiency (W/W)
		±5%	±5%	±5%	±5%	±7%
35°C	10	1 132	220	1.03	11.71	5.15
	5	954	208	0.97	9.83	4.59
	0	789	195	0.90	8.11	4.04
	-5	640	182	0.84	6.56	3.52
	-10	508	167	0.77	5.19	3.04
	-15	396	151	0.70	4.04	2.63

Condensing Temperature (°C)	Evaporating Temperature (°C)	Cooling Capacity (W)	Power Consumption (W)	Current Consumption (A)	Gas Flow Rate (kg/h)	Efficiency (W/W)
		±5%	±5%	±5%	±5%	±7%
45°C	10	1 031	251	1.16	11.48	4.11
	5	864	235	1.08	9.59	3.68
	0	709	218	1.00	7.85	3.25
	-5	570	201	0.92	6.28	2.83
	-10	447	183	0.84	4.92	2.45
	-15	343	162	0.75	3.76	2.11

Condensing Temperature (°C)	Evaporating Temperature (°C)	Cooling Capacity (W)	Power Consumption (W)	Current Consumption (A)	Gas Flow Rate (kg/h)	Efficiency (W/W)
		±5%	±5%	±5%	±5%	±7%
55°C	10	922	284	1.32	11.16	3.25
	5	773	263	1.21	9.31	2.94
	0	634	242	1.11	7.62	2.62
	-5	510	220	1.01	6.10	2.31
	-10	401	198	0.91	4.79	2.03

Test condition: ASHRAE, Static, Return Gas 35°C, Subcooling 8.3K, Ambient: 35°C

ASSEMBLY INSTRUCTION

WIRING DIAGRAM

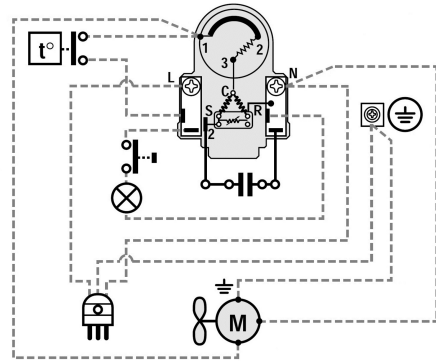
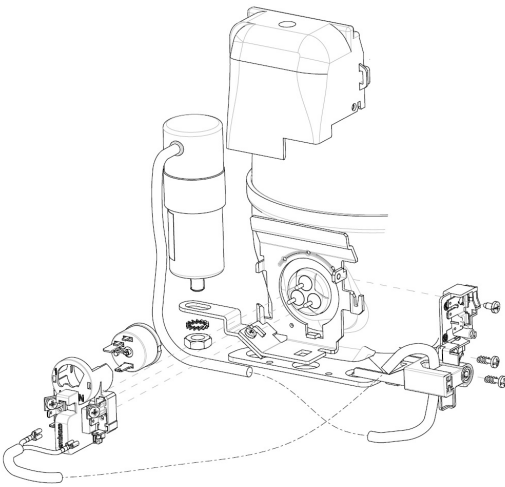

OPERATING ENVELOPE

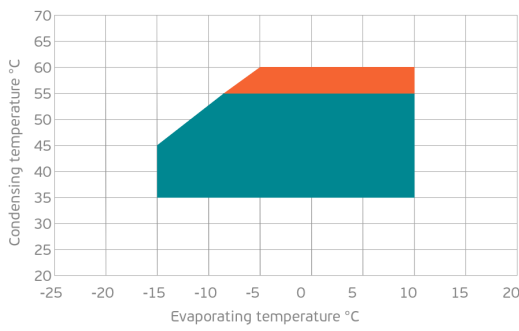

- Operating Condition
- Transient Condition
- Superheating

NOTE: usage of compressors outside of intended working range cannot make use of the warranty, or should be consulted with Technical support.

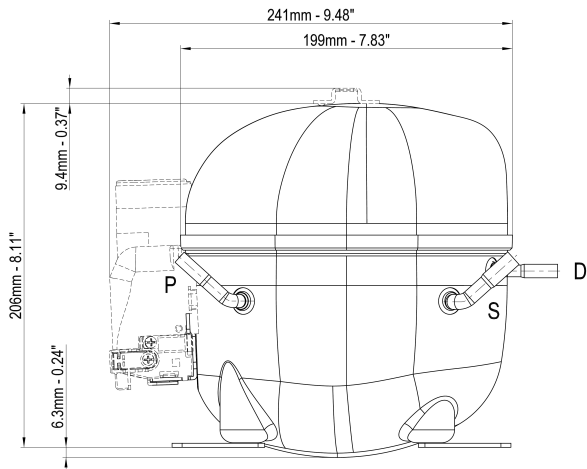

	∅ mm	∅ in	Material
S - Suction	6.10 - 6.20	0.24	Cu
P - Process	6.10 - 6.20	0.24	Cu
D - Discharge	4.86 - 5.03	0.19	Cu

